



INDUSTRIAL

FOR SALE

**3636 N. Talman
Chicago, IL**

SIZE: Building: ± 30,000 sf
Site: 46,914 sf
Parking: ± 50 cars

BUILDING FEATURES:

Power: 2400 amps / 3 phase
Floor Load: Concrete
Ceiling Height: Center section is 24' total height, 15' to the joist, and clear span. Sides are 12'.
Truck-level docks: 2 internal on Talman, no levelators
Sprinklered: yes
Heat: Steam boiler
Possession: Immediate
Age: 1952
Zoning: M2-2

SALE PRICE: \$ 3,000,000

TAXES: \$ 27,267.38 (2005)

REMARKS: Metal truss, flat roof. 3-ton crane on one side.
1000 sf office.

AGENT: **Brian Ripp** 312-337-1985
bripp@kritt.com

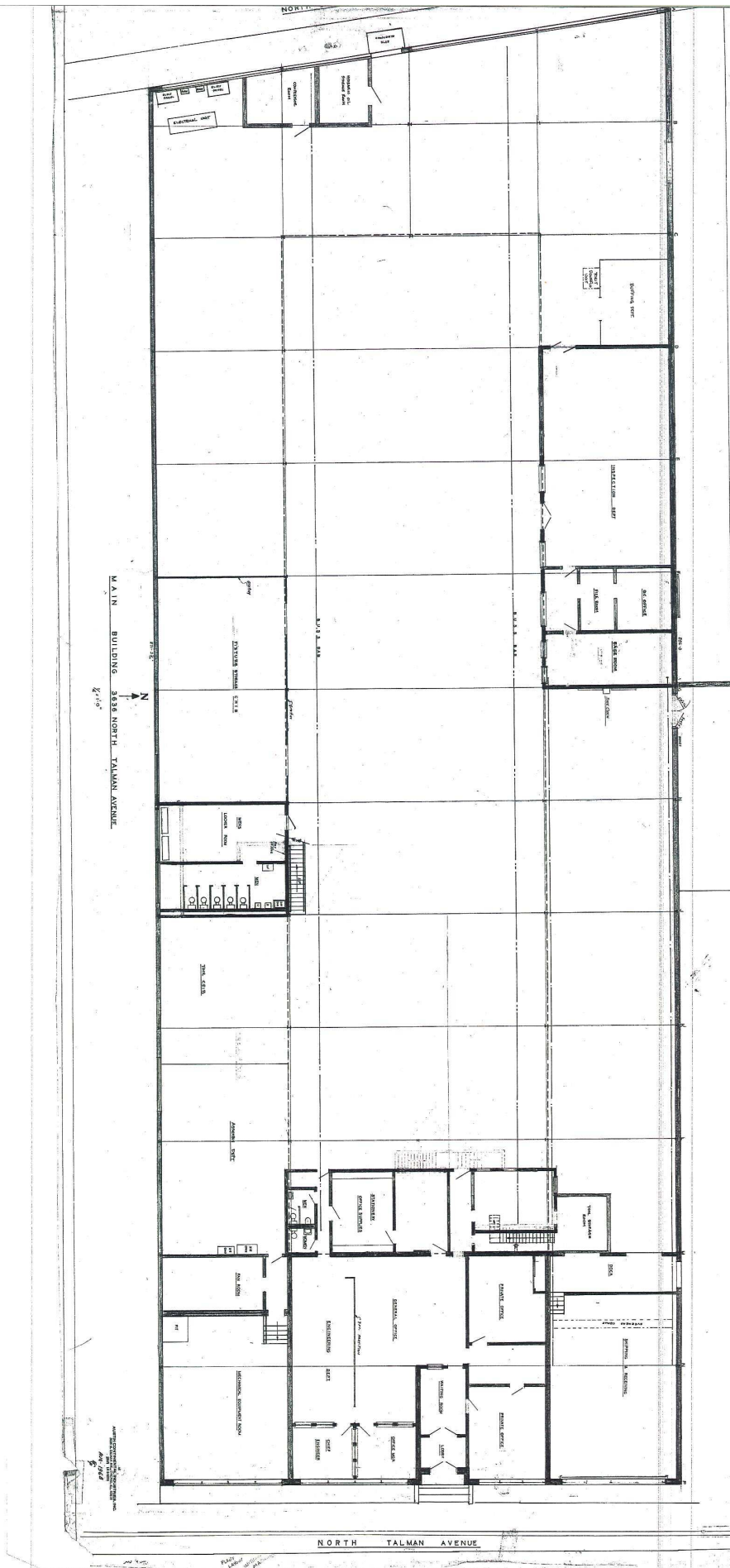

Above information is from sources believed reliable. No responsibility is taken for errors or omissions.
 Property is offered subject to change in status or withdrawal without notice.